





# Standard cylinder——SE Series

In accordance with ISO15552 and VDMA24562 standard

## Product series

Series name	Mounting type									Acting type	Bore size	Collocation of sensor switch	
	Basic	LB	FA	FB	CA	CB	CR	TC	FTC			CS1-E	DS1-E
Double acting type: SE 	●	●	●	●	●	●	●	●	●	Double acting	32 40 50 63 80 100 125	●	●
Double rod type: SED 	●	●	●				●	●				●	●
Adjustable stroke type: SEJ 	●	●	●				●	●				●	●
	●	●	●				●	●				●	●
	●	●	●				●	●				●	●
	●	●	●				●	●				●	●
Page	170			172						419			



## Installation and application

- When load changes in the work, the cylinder with abundant output capacity shall be selected.
- Relative cylinder with high temperature resistance or corrosion resistance shall be chosen under the condition of high temperature or corrosion.
- Necessary protection measure shall be taken in the environment with higher humidity, much dust or water drops, oil dust and welding dregs.
- Dirty substances in the pipe must be eliminated before cylinder is connected with pipeline to prevent the entrance of particles into the cylinder.
- The medium used by cylinder shall be filtered to 40 μm or below.
- Anti-freezing measure shall be adopted under low temperature environment to prevent moisture freezing.
- The cylinder shall be carried out test run without load before application. Prior to run, buffer shall be turned to the minimum and gradually released to avoid the damage on cylinder caused by excessive impact.
- The cylinder shall avoid the influence of side load in operation to maintain the normal work of cylinder and extend the service life.
- If the cylinder is dismantled and stored for a long time, please conduct anti-rust treatment to the surface. Anti-dust caps shall be added in air inlet and outlet ports.

## Criteria for selection: Cylinder thrust

Unit: Newton(N)

Bore size (mm)	Rod size (mm)	Acting type	Pressure area (mm <sup>2</sup> )	Operating pressure (MPa)								
				0.1	0.2	0.3	0.4	0.5	0.6	0.7	0.8	0.9
32	12	Double acting Push side	804	80.4	160.8	241.2	321.6	402.0	482.4	562.8	643.2	723.6
		Double acting Pull side	690	69.0	138.0	207.0	276.0	345.0	414.0	483.0	552.0	621.0
40	16	Double acting Push side	1256	125.6	251.2	376.8	502.4	628.0	753.6	879.2	1002.4	1130.4
		Double acting Pull side	1055	105.5	211.0	316.5	422.0	527.5	633.0	738.5	844.0	949.5
50	20	Double acting Push side	1963	196.3	392.6	588.9	785.2	981.5	1177.8	1374.1	1570.4	1766.7
		Double acting Pull side	1649	164.9	329.8	494.7	659.6	824.5	989.4	1154.3	1399.2	1484.1
63	20	Double acting Push side	3117	311.7	623.4	935.1	1246.8	1558.5	1870.2	2181.9	2493.6	2805.3
		Double acting Pull side	2803	280.3	560.6	840.9	1121.2	1401.5	1681.8	1962.1	2242.4	2522.7
80	25	Double acting Push side	5026	502.6	1005.2	1507.8	2010.4	2513.0	3015.6	3518.2	4020.8	4523.4
		Double acting Pull side	4536	453.6	907.2	1360.8	1814.4	2268.0	2721.6	3175.2	3628.8	4082.4
100	25	Double acting Push side	7853	785.3	1570.6	2355.9	3141.2	3926.5	4711.8	5497.1	6282.4	7067.7
		Double acting Pull side	7362	736.2	1472.4	2208.6	2944.8	3681.0	4417.2	5153.4	5889.6	6625.8
125	32	Double acting Push side	12272	1227.2	2454.4	3681.6	4908.8	6136.0	7363.2	8590.4	9817.6	11044.8
		Double acting Pull side	11468	1146.8	2293.6	3440.4	4587.2	5734.0	6880.8	8027.6	9174.4	10321.2



# ISO15552 Standard cylinder



## SE Series

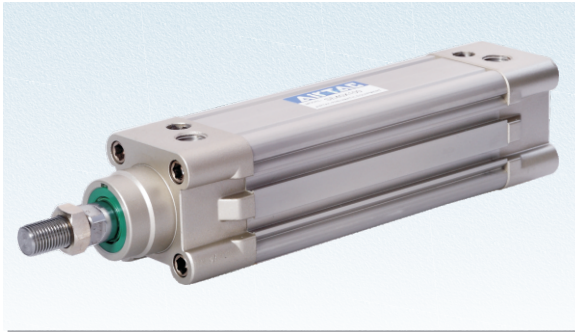

### Symbol

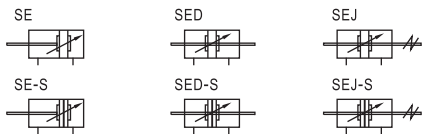

### Product feature

1. ISO15552 and VDMA24562 standard cylinder;
2. The piston seal is composed of two Y-shape one-way seal structure, which has compensation function, long service life and low start-up pressure;
3. The square aluminum pipe without tie rod has good corrosion resistance;
4. The buffer adjustment of cylinder is smooth and steady;
5. Cylinders and accessories for installation with several specifications are optional.

### Specification

Bore size(mm)	32	40	50	63	80	100	125					
Acting type	Double acting											
Fluid	Air(to be filtered by 40 μm filter element)											
Mounting type	SE	Basic	FA	FB	CA	CB	CR	LB	TC	FTC	TCM1	TCM2
	SED, SEJ	Basic	FA	LB	TC	FTC	TCM1	TCM2				
Operating pressure	0.1~1.0MPa(15~145psi)(1.0~10.0bar)											
Proof pressure	1.5MPa(215psi)(15bar)											
Temperature °C	-20~80											
Speed range mm/s	30~800							30~500				
Stroke tolerance	0~250 <sup>+1.0</sup> <sub>0</sub>							251~1000 <sup>+1.4</sup> <sub>0</sub>	1001~1500 <sup>+1.8</sup> <sub>0</sub>			
Cushion type	Variable cushion											
Adjustable cushion stroke mm	27		30			36		40				
Port size ①	1/8"		1/4"		3/8"		1/2"					

① PT thread, NPT thread and G thread are available.  
Add) Refer to P419~442 for detail of sensor switch.

### Stroke

Bore size (mm)	Standard stroke (mm)	Max. std stroke	Max. stroke
32	25 50 75 80 100 125 150 160 175 200 250 300 350 400 450 500	1000	1800
40	25 50 75 80 100 125 150 160 175 200 250 300 350 400 450 500 600 700 800	1200	1800
50	25 50 75 80 100 125 150 160 175 200 250 300 350 400 450 500 600 700 800 900 1000	1200	1800
63	25 50 75 80 100 125 150 160 175 200 250 300 350 400 450 500 600 700 800 900 1000	1500	1800
80	25 50 75 80 100 125 150 160 175 200 250 300 350 400 450 500 600 700 800 900 1000	1500	1800
100	25 50 75 80 100 125 150 160 175 200 250 300 350 400 450 500 600 700 800 900 1000	1500	1800
125	25 50 75 80 100 125 150 160 175 200 250 300 350 400 450 500 600 700 800 900 1000	1500	1800

Note) Consult us for non-standard stroke.

### Ordering code

SE 80 □ × 50 S □ □ □

SED 80 □ × 50 S □ □ □

SEJ 80 □ × 50-20 S □ □ □

<p><b>Model</b></p> <ul style="list-style-type: none"> <li>SE: Double acting type</li> <li>SED: Double rod type</li> <li>SEJ: Adjustable stroke type</li> </ul>	<p><b>Thread type</b></p> <ul style="list-style-type: none"> <li>Blank: PT</li> <li>T: NPT</li> <li>G: G</li> </ul>																														
<p><b>Bore size</b></p> <p>32 40 50 63 80 100 125</p>	<p><b>Seals Material</b></p> <ul style="list-style-type: none"> <li>Blank: TPU</li> <li>H: Viton</li> <li>N: NBR</li> </ul>																														
<p><b>Rod Material</b></p> <ul style="list-style-type: none"> <li>Blank: Medium carbon steel</li> <li>A: SUS420J2</li> <li>B: SUS304</li> <li>C: SUS316</li> </ul>	<p><b>Mounting type</b> ①</p> <table border="1"> <thead> <tr> <th>Mounting type</th> <th>Available series</th> <th>Memo</th> </tr> </thead> <tbody> <tr> <td>Blank</td> <td>SE</td> <td></td> </tr> <tr> <td>LB</td> <td>SE</td> <td></td> </tr> <tr> <td>FA</td> <td>SEJ</td> <td></td> </tr> <tr> <td>FB</td> <td>SEJ</td> <td></td> </tr> <tr> <td>CA</td> <td>SE</td> <td></td> </tr> <tr> <td>CB</td> <td>SE</td> <td></td> </tr> <tr> <td>CR</td> <td>SE</td> <td>Be used with CB</td> </tr> <tr> <td>FTC</td> <td>SE</td> <td>Be used with TCM1</td> </tr> <tr> <td>TC</td> <td>SEJ</td> <td>Be used with TCM2</td> </tr> </tbody> </table>	Mounting type	Available series	Memo	Blank	SE		LB	SE		FA	SEJ		FB	SEJ		CA	SE		CB	SE		CR	SE	Be used with CB	FTC	SE	Be used with TCM1	TC	SEJ	Be used with TCM2
Mounting type	Available series	Memo																													
Blank	SE																														
LB	SE																														
FA	SEJ																														
FB	SEJ																														
CA	SE																														
CB	SE																														
CR	SE	Be used with CB																													
FTC	SE	Be used with TCM1																													
TC	SEJ	Be used with TCM2																													
<p><b>Stroke</b></p> <p>Refer to stroke table for details</p>	<p><b>Adjustable stroke</b></p> <ul style="list-style-type: none"> <li>10: 10mm</li> <li>20: 20mm</li> <li>30: 30mm</li> <li>40: 40mm</li> <li>50: 50mm</li> <li>75: 75mm</li> <li>100: 100mm</li> </ul>																														
<p><b>Magnet</b></p> <ul style="list-style-type: none"> <li>Blank: Without magnet</li> <li>S: With magnet</li> </ul>																															

① Please refer to page 172~174 for accessory parts.



# ISO15552 Standard cylinder

## SE Series

### Inner structure and material of major parts

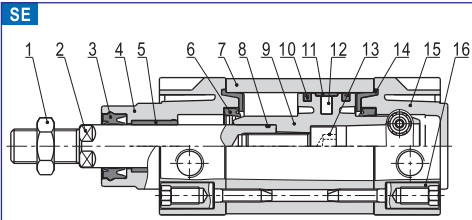

NO.	Item	Material
1	Rod nut	Carbon steel\Stainless steel
2	Piston rod	Carbon steel with 20 μ m chrome plated or Stainless steel
3	Front cover packing	TPU
4	Front cover	Aluminum alloy
5	Bushing	Wear resistant material
6	Cushing O-ring	TPU
7	Barrel	Aluminum alloy
8	O-ring	NBR
9	Piston	Aluminum alloy
10	Piston Seal	TPU
11	Wear ring	Wear resistant material
12	Magnet	Plastic\Rubber(Φ 125)
13	Bolt	Carbon steel
14	Buffer gasket	TPU
15	Back cover	Aluminum alloy
16	Screw	Carbon steel\Stainless steel

### Dimensions

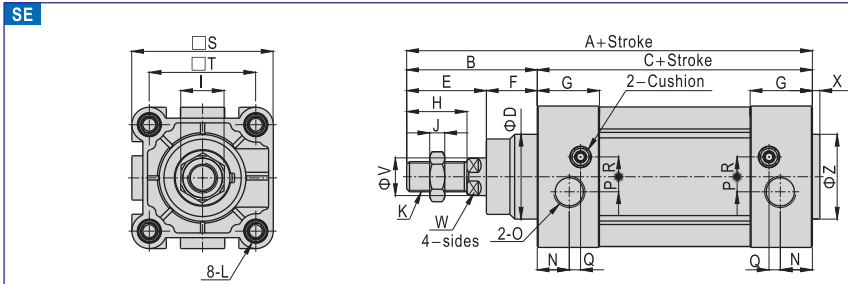

Bore size\Item	A	B	C	D	E	F	G	H	I	J	K
32	142	48	94	30	29	19	27.5	22	17	6	M10×1.25
40	159	54	105	35	33	21	32	24	17	7	M12×1.25
50	175	69	106	40	42	27	31	32	23	8	M16×1.5
63	190	69	121	45	42	27	33	32	23	8	M16×1.5
80	214	86	128	45	53	33	33	40	26	10	M20×1.5
100	229	91	138	55	55	36	37	40	26	10	M20×1.5
125	279	119	160	60	74	45	46	54	41	13.5	M27×2

Bore size\Item	L	N	O	P	Q	R	S	T	V	W	X	Z
32	M6	13.5	1/8"	5.8	6	6.3	46.5	32.5	12	10	3	30
40	M6	17.5	1/4"	6	5.5	9	54	38	16	13	3.5	35
50	M8	14	1/4"	8	5	10.5	64	46.5	20	17	3.5	40
63	M8	17	3/8"	8	6	10.5	75	56.5	20	17	4	45
80	M10	16.5	3/8"	8	8.5	12.5	93	72	25	22	4	45
100	M10	19.5	1/2"	10	7	12	110	89	25	22	4	55
125	M12	23	1/2"	11	12	11	134	110	32	27	4	60

Remark: The dimensions of magnet type cylinder are the same as non-magnet type cylinder.

### SED

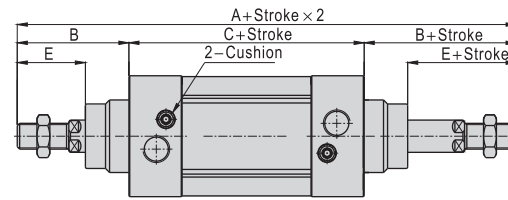

### SEJ

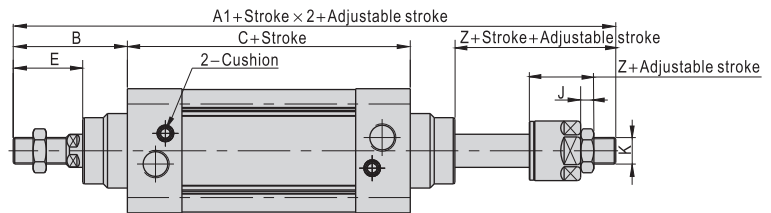

Bore size\Item	A	A1	B	C	E	Z	J	K
32	190	188	48	94	29	27	6	M10X1.25
40	213	208	54	105	33	28	7	M12X1.25
50	244	231	69	106	42	29	8	M16X1.5
63	259	246	69	121	42	29	8	M16X1.5
80	300	282.5	86	128	53	35.5	10	M20X1.5
100	320	300.5	91	138	55	35.5	10	M20X1.5
125	398	366.5	119	160	74	42.5	13.5	M27X2.0

Remark:

1. The dimensions of magnet type cylinder are the same as non-magnet type cylinder.
2. The unmarked dimension is the same as SE standard type.



SE

# ISO1552 Standard cylinder



## Accessories

### Ordering code

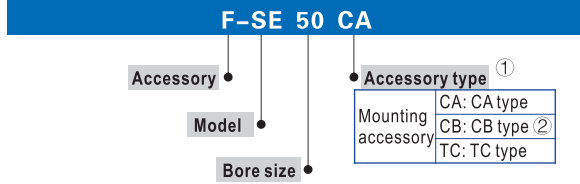

- ① The listed accessories are for SE cylinder. Accessories that are adaptable to other cylinders are not shown. Please refer to accessory list on P174 for selection and ordering information.  
 ② CB is attached with relevant PIN.



SE

### Accessory selection

Accessories	SE		SED		SEJ	
	Standard	With magnet	Standard	With magnet	Standard	With magnet
<b>Mounting accessory</b>						
LB	●	●	●	●	●	●
FA	●	●	●	●	●	●
FB	●	●	×	×	×	×
CA	●	●	×	×	×	×
CB	●	●	×	×	×	×
CR	●	●	×	×	×	×
TC	●	●	●	●	●	●
FTC	●	●	●	●	●	●
TCM1	●	●	●	●	●	●
TCM2	●	●	●	●	●	●
<b>Knuckle</b>						
I	●	●	●	●	●	●
Y	●	●	●	●	●	●
U	●	●	●	●	●	●
F	●	●	●	●	●	●
<b>Sensor switch</b>						
CS1-E	×	●	×	●	×	●
CS1-EX	×	●	×	●	×	●
DS1-E	×	●	×	●	×	●
DS1-EN	×	●	×	●	×	●
DS1-EP	×	●	×	●	×	●

- ① Please refer to P415~418 for knuckle detail.  
 ② Please refer to P419~442 for detail of sensor switch.

### Material of accessories

Accessories	Mounting accessories										Knuckle		
	LB	FA	FB	CA	CB	CR	FTC	TCM1	TCM2	I	Y	F	U
Bore size 32~100	○	●	●	◇	◇	◇	■	■	■	■	□	□	□
125	■	■	■	■	■	■	■	■	■	■	□	□	□

- Aluminum alloy, ▲—S45C, ■—Cast steel,  
 ○—Low carbon steel, ◇—Nodular cast iron, □—Carbon steel.

### Dimensions

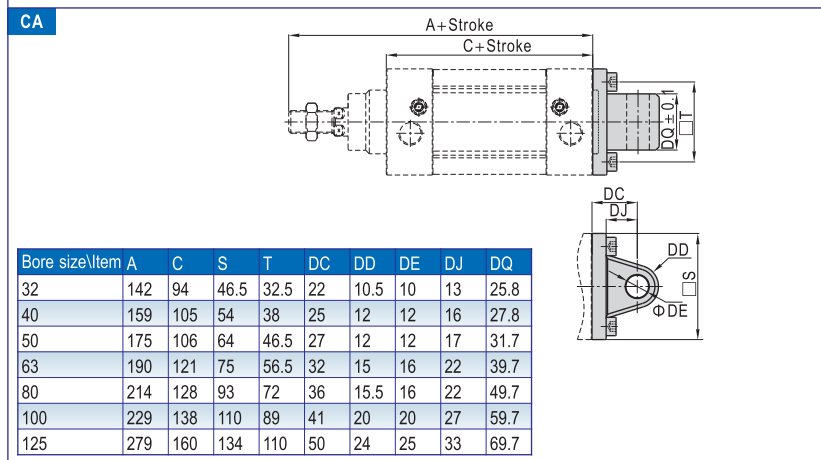
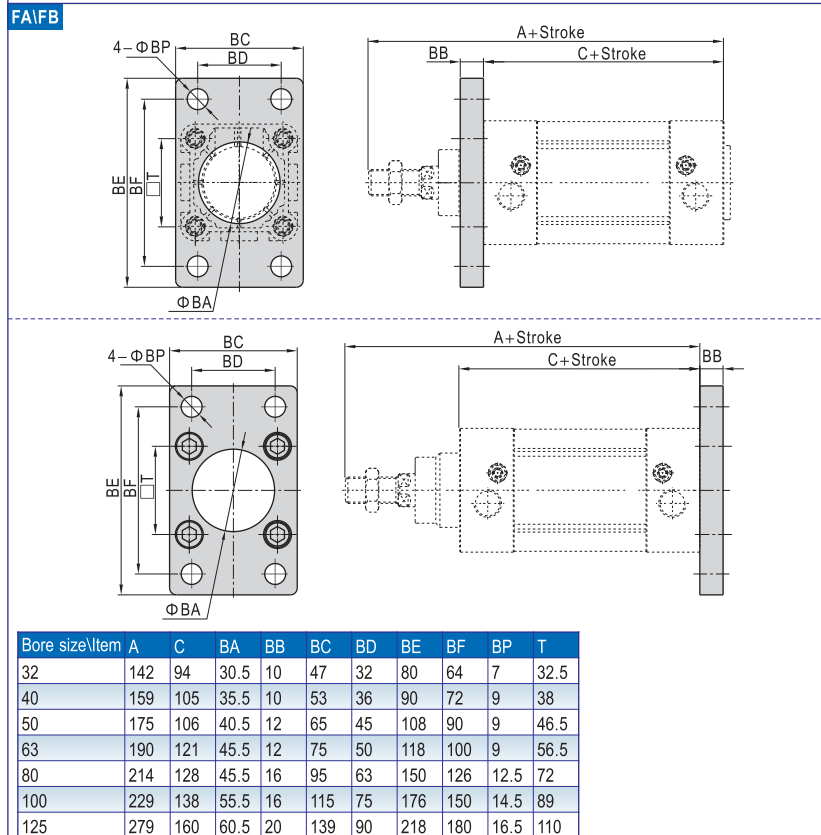
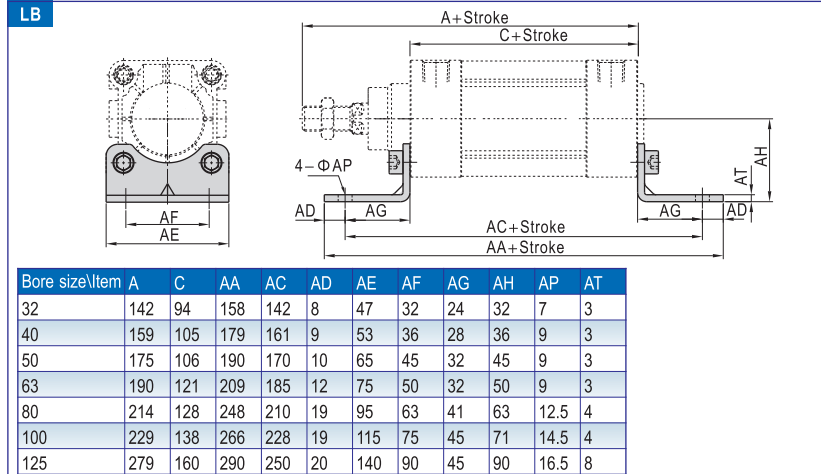

# ISO1552 Standard cylinder

## Accessories

### CB

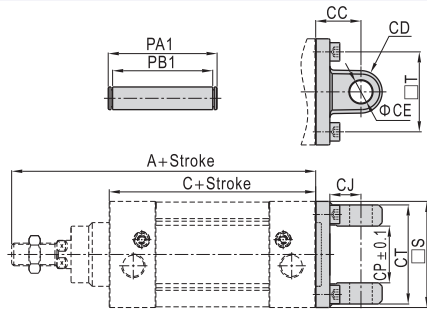

Bore size\Item	A	C	CC	CD	CE	CJ	CP	CT	PA1	PB1	S	T
32	142	94	22	10.5	10	13	26	45	51	45.5	46.5	32.5
40	159	105	25	12	12	16	28	52	59	52.5	54	38
50	175	106	27	12	12	17	32	60	67	60.5	64	46.5
63	190	121	32	15	16	22	40	70	77	70.5	75	56.5
80	214	128	36	15.5	16	22	50	90	97	90.5	93	72
100	229	138	41	20	20	27	60	110	119	110.5	110	89
125	279	160	50	24	25	33	70	130	139	130.5	134	110

### CR

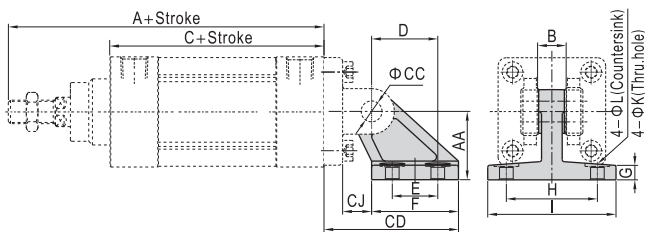

Bore size\Item	A	AA	B	C	CC	CD	CJ	D	E	F	G	H	I	K	L
32	142	32	26	94	10	50	10	21	18	31	8	38	51	6.6	-
40	159	36	28	105	12	56	12	24	22	35	10	41	54	6.6	-
50	175	45	32	106	12	68	13	33	30	45	12	50	65	9	-
63	190	50	40	121	16	77	17	37	35	50	12	52	67	9	-
80	214	63	50	128	16	93	19	47	40	60	14	66	86	11	18
100	229	71	60	138	20	106	22	55	50	70	15	76	96	11	18
125	279	90	70	160	25	135	26	70	60	90	20	94	124	14	20

Note) CR can't be used alone, it must be used with CB.

### FTC

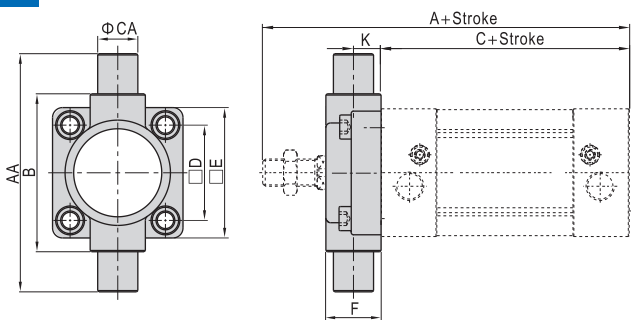

Bore size\Item	A	C	AA	B	CA	D	E	F	K
32	142	94	74	50	12	32.5	46	19	10
40	159	105	95	63	16	38	52	21	10
50	175	106	107	75	16	46.5	64	26	12
63	190	121	130	90	20	56.5	74	28	12
80	214	128	150	110	20	72	94	31	16
100	229	138	182	132	25	89	114	35	16
125	279	160	210	160	25	110	139	43	20

### TCM1

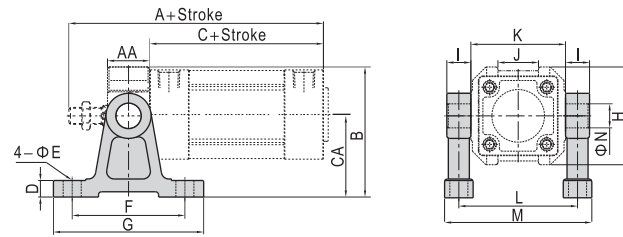

Bore size\Item	A	C	AA	B	CA	D	E	F	G	H	I	J	K	L	M	N
32	142	94	19	66	40	11	9	60	80	52	12	20	50	62	77	12
40	159	105	21	86.5	54	11	12	75	100	65	16	27	63	79	98	16
50	175	106	26	91.5	54	11	12	75	100	75	16	31	75	91	110	16
63	190	121	28	115	70	11	12	85	110	90	20	42	90	110	133	20
80	214	128	31	126	70	11	12	85	110	112	20	54	110	130	153	20
100	229	138	35	157.5	90	19	18	115	155	135	25	68	135	157	185	25
125	279	160	43	169.3	90	19	18	115	155	170	25	80	160	185	213	25

Note) The installation position of the accessories can not be adjusted arbitrarily.

### TCM2

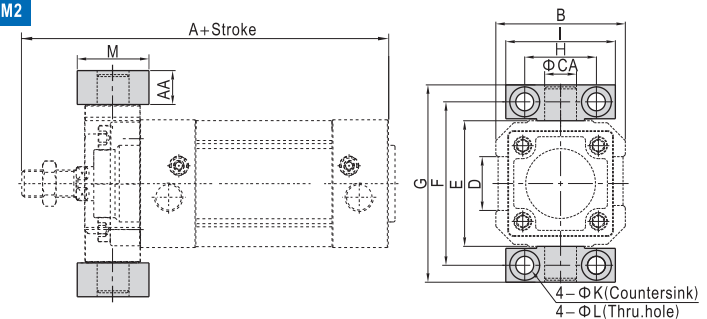

Bore size\Item	A	AA	B	CA	D	E	F	G	H	I	K	L	M
32	142	14	52	12	20	50	66	80	32	46	11	7	30
40	159	17	65	16	27	63	82	99	36	55	15	9	36
50	175	17	75	16	31	75	94	111	36	55	15	9	36
63	190	20.5	90	20	42	90	113.5	134	42	65	18	11	40
80	214	20.5	112	20	54	110	133.5	154	42	65	18	11	40
100	229	24.5	135	25	68	132	159.5	184	50	75	20	14	50
125	279	24.5	170	25	80	160	187.5	212	50	75	20	14	50

Note) The installation position of the accessories can not be adjusted arbitrarily.



SE

# Cylinder joint accessory



## Y Knuckle



### Ordering code

**F-M16X150 Y**

Accessories code

Knuckle

Y: Y Knuckle

Screw thread

M3: M3
M4: M4
M5: M5
M6: M6
M8: M8
M10: M10
M12: M12
M14: M14
M16: M16
M18: M18
M20: M20
M22: M22
M26: M26
M27: M27
M36: M36
M42: M42

Thread pitch

Screw thread	Thread pitch
M3	050: 0.5mm
M4	070: 0.7mm
M5	080: 0.8mm
M6	100: 1.0mm
M8, M10, M12	125: 1.25mm
M14, M16, M18	150: 1.5mm
M20, M22, M26	200: 2.0mm
M27, M36, M42	

### Table for Y knuckle and cylinder

Cylinder Accessory	SE						SI/SIF									
	32	40	50	63	80	100	125	32	40	50	63	80	100	125	160	200
F-M10X125Y	●							●								
F-M12X125Y		●							●							
F-M16X150Y			●	●						●	●					
F-M20X150Y					●	●						●	●			
F-M27X200Y							●							●		
F-M36X200Y															●	●

Cylinder Accessory	SGC				SC/SCF/SU/SUF				JSI								
	125	160	200	250	32	40	50	63	80	100	32	40	50	63	80	100	125
F-M10X125Y					●						●						
F-M12X125Y						●											
F-M14X150Y												●					
F-M16X150Y							●	●									
F-M18X150Y													●	●			
F-M20X150Y									●	●							
F-M22X150Y															●		
F-M26X150Y																●	
F-M27X200Y	●																●
F-M36X200Y		●	●														
F-M42X200Y				●													

Cylinder Accessory	MI						MPG						
	8	10	12	16	20	25	32	40	6	8	10	12	16
F-M3X050Y									●				
F-M4X070Y	●	●								●	●		
F-M5X080Y											●	●	
F-M6X100Y			●	●									
F-M8X125Y					●								
F-M10X125Y						●	●						
F-M12X125Y								●					

### Dimensions

#### M10 and below

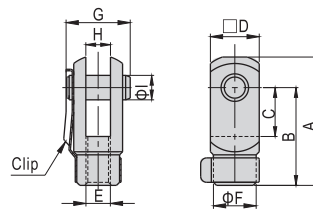

Type/Item	A	B	C	D	F
F-M3X050Y	15.5	12	5	6	6
F-M4X070Y	22	16	8	8	7
F-M5X080Y	28	21	10.2	12	10
F-M6X100Y	32	24	12	12	10
F-M8X125Y	42	32	16	16	14
F-M10X125Y	52	40	20	19	18

Type/Item	E	G	H	I
F-M3X050Y	M3×0.5	9	3	3
F-M4X070Y	M4×0.7	11.5	4	4
F-M5X080Y	M5×0.8	15.5	6.5	5
F-M6X100Y	M6×1.0	16	6	6
F-M8X125Y	M8×1.25	21	8	8
F-M10X125Y	M10×1.25	25	10	10

#### M14\M18\M22\M26

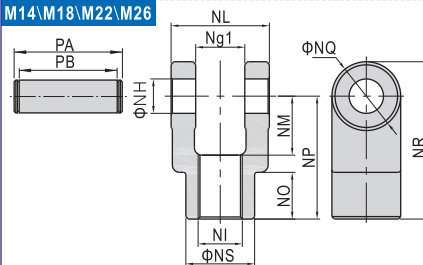

Type/Item	NG1	NH	NI	NL	NM
F-M14X150Y	14.2	10	M14×1.5	27.8	19
F-M18X150Y	20.2	14	M18×1.5	39.8	24
F-M22X150Y	30.2	22	M22×1.5	59.8	34
F-M26X150Y	30.2	22	M26×1.5	59.8	34

Type/Item	NO	NP	NQ	NR	NS	PA	PB
F-M14X150Y	17	40	22	51	22	34.6	28.8
F-M18X150Y	19	50	28	64	28	47	40.8
F-M22X150Y	20	65	40	85	40	69.2	60.8
F-M26X150Y	20	65	40	85	40	69.2	60.8

#### Others

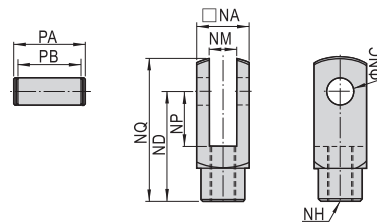

Type/Item	NA	NC	ND	NP	NQ
F-M12X125Y	25.4	12	48	24	62
F-M16X150Y	32	16	64	32	80
F-M20X150Y	44.4	20	80	40	102
F-M27X200Y	54	30	110	55	139
F-M36X200Y	70	35	144	73	179
F-M42X200Y	85	40	168	86	211

Type/Item	NM	NH	PA	PB
F-M12X125Y	12	M12×1.25	32.4	26.2
F-M16X150Y	16	M16×1.5	39	32.8
F-M20X150Y	20	M20×1.5	53.4	45.2
F-M27X200Y	30	M27×2.0	64.2	54.8
F-M36X200Y	35	M36×2.0	80.2	70.8
F-M42X200Y	40.3	M42×2.0	115	93



Y knuckle



# Cylinder joint accessory

## Floating Joint



### Ordering code

**F-M10X125 F**

Accessories code: **F** (Floating joint)

Code: **F** (Floating joint)

Screw thread		Thread pitch	
M3: M3	M3	050: 0.5mm	
M4: M4	M4	070: 0.7mm	
M5: M5	M5	080: 0.8mm	
M6: M6	M6	100: 1.0mm	
M8: M8	M8	125: 1.25mm	
M10: M10	M8, M10, M12	125: 1.25mm	
M12: M12	M14, M16	150: 1.5mm	
M14: M14	M18, M20	150: 1.5mm	
M16: M16			
M18: M18			
M20: M20			

### Table for floating joint and cylinder

Cylinder	SE						SI								
Accessory	32	40	50	63	80	100	32	40	50	63	80	100	125	160	200
F-M10X125F	•						•								
F-M12X125F		•						•							
F-M16X150F			•	•					•	•					
F-M20X150F					•	•					•	•			

Cylinder	SGC				SC/SCF/SU/SUF				JSI								
Accessory	125	160	200	250	32	40	50	63	80	100	32	40	50	63	80	100	125
F-M10X125F					•						•						
F-M12X125F						•						•					
F-M14X150F													•				
F-M16X150F							•	•						•	•		
F-M18X150F															•	•	
F-M20X150F											•	•					

Cylinder	ACP						ACQ														
Accessory	12	16	20	25	32	40	50	63	80	100	12	16	20	25	32	40	50	63	80	100	
F-M8X125F		•													•						
F-M10X125F			•	•	•	•										•					
F-M12X125F							•	•													
F-M14X150F																	•	•			
F-M16X150F									•										•	•	
F-M18X150F																				•	•
F-M20X150F										•											

Cylinder	MA				MAL				MF						
Accessory	16	20	25	32	40	50	63	20	25	32	40	20	25	32	40
F-M6X100F	•														
F-M8X125F		•						•				•			
F-M10X125F			•	•				•	•		•	•			
F-M12X125F					•										
F-M14X150F						•	•								•

Cylinder	PB				MI								
Accessory	4	6	10	12	16	8	10	12	16	20	25	32	40
F-M3X050F		•											
F-M4X070F			•			•	•						
F-M5X080F				•	•								
F-M6X100F								•	•				
F-M8X125F										•			
F-M10X125F											•	•	
F-M12X125F													•

### Dimensions

#### M6 and below

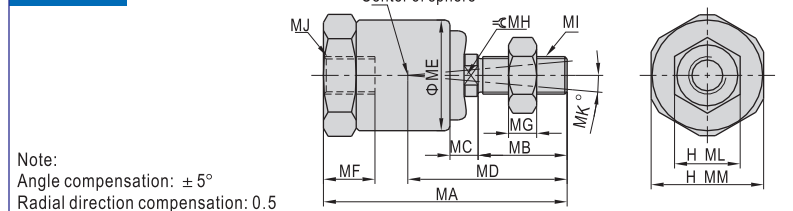

Type/Item	MA	MB	MC	MD	ME	MF	MG	MH	MI	MJ	ML	MM
F-M3X050F	23.5	7.5	3	15	11.8	5.5	2.4	4	M3×0.5	5.5	12	
F-M4X070F	26	9.5	3	17	11.8	6	3	4	M4×0.7	7	12	
F-M5X080F	34.5	13.5	3.5	22.8	13.8	8	4	6	M5×0.8	8	14	
F-M6X100F	34.5	13.5	3.5	22.8	13.8	8	4	6	M6×1.0	10	14	

#### M8 and above

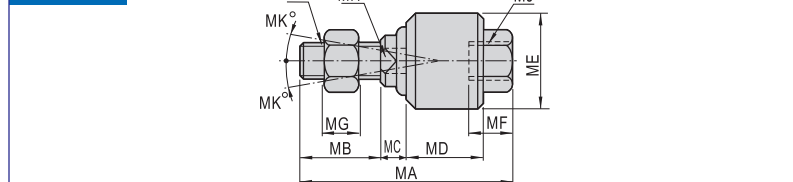

Type/Item	MA	MB	MC	MD	ME	MF	MG	MH	MI	MJ	MK
F-M8X125F	51	20	6	17	24	10.5	6	8	M8×1.25	M8×1.25	13
F-M10X125F	58	22	7	21	26	11	6	10	M10×1.25	M10×1.25	12
F-M12X125F	58	22	8	21	28	11.5	7	12	M12×1.25	M12×1.25	12
F-M14X150F	70	22.5	8.5	28	34.5	16	8	15	M14×1.5	M14×1.5	12
F-M16X150F	90	27	10	41	44.5	19	8	17	M16×1.5	M16×1.5	7
F-M18X150F	92	27	10	41	44.5	21	11	18	M18×1.5	M18×1.5	7
F-M20X150F	102	29	13	46	53	22	10	22	M20×1.5	M20×1.5	10



Floating Joint

# Cylinder joint accessory



## Universal Joint



### Ordering code

**F-M10X125 U**

Accessories code

- Code: U: Universal joint

Screw thread

M4: M4
M5: M5
M6: M6
M8: M8
M10: M10
M12: M12
M14: M14
M16: M16
M18: M18
M20: M20
M27: M27
M36: M36

Thread pitch

Screw thread	Thread pitch
M4	070: 0.7mm
M5	080: 0.8mm
M6	100: 1.0mm
M8, M10, M12	125: 1.25mm
M14, M16	150: 1.5mm
M27, M36	200: 2.0mm

### Table for universal joint and cylinder

Cylinder Accessory	SE						SI								
	32	40	50	63	80	100	32	40	50	63	80	100	125	160	200
F-M10X125U	●						●								
F-M12X125U		●						●							
F-M16X150U			●	●					●	●					
F-M20X150U					●	●					●	●			
F-M27X200U							●						●		
F-M36X200U														●	●

Cylinder Accessory	SGC				SC/SCF/SU/SUF				JSI							
	125	160	200	250	32	40	50	63	80	32	40	50	63	80	100	125
F-M10X125U					●						●					
F-M12X125U						●										
F-M14X150U											●					
F-M16X150U							●	●								
F-M18X150U											●	●				
F-M20X150U									●	●						
F-M27X200U	●															●
F-M36X200U		●	●													

Cylinder Accessory	ACP								ACQ											
	12	16	20	25	32	40	50	63	80	100	12	16	20	25	32	40	50	63	80	100
F-M5X080U												●								
F-M6X100U	●												●							
F-M8X125U		●												●						
F-M10X125U			●	●	●	●								●						
F-M12X125U							●	●												
F-M14X150U															●	●				
F-M16X150U									●											
F-M18X150U																	●	●		
F-M20X150U										●										

Cylinder Accessory	MA				MAL				MF							
	16	20	25	32	40	50	63	20	25	32	40	20	25	32	40	
F-M6X100U	●															
F-M8X125U		●						●					●			
F-M10X125U			●	●					●	●			●	●		
F-M12X125U					●						●					
F-M14X150U						●	●									●

Cylinder Accessory	PB				MI								
	4	6	10	12	16	8	10	12	16	20	25	32	40
F-M4X070U			●					●	●				
F-M5X080U				●	●								
F-M6X100U									●	●			
F-M8X125U										●			
F-M10X125U											●	●	
F-M12X125U												●	●

### Dimensions

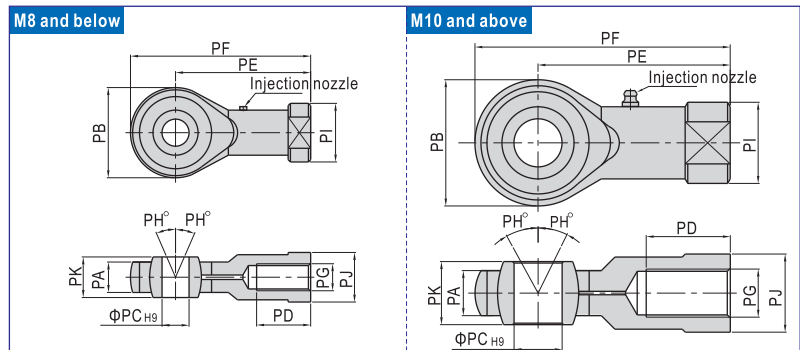

Type/Item	PA	PB	PC	PD	PE	PF	PG	PH	PI	PJ	PK
F-M4X070U	6	18	5	10	27	36	M4×0.7	13	12.5	10	8
F-M5X080U	6	18	5	10	27	36	M5×0.8	13	12.5	10	8
F-M6X100U	6.8	20	6	12	30	40	M6×1.0	13	13	11	9
F-M8X125U	9	24	8	16	36	48	M8×1.25	13	16	14	12
F-M10X125U	11	26	10	20	43	56	M10×1.25	13	19	17	14
F-M12X125U	12	32	12	22	50	66	M12×1.25	13	22	19	16
F-M14X150U	14	36	14	28	57	75	M14×1.5	13	25	22	19
F-M16X150U	15	40	16	28	64	84	M16×1.5	15	27	22	21
F-M18X150U	16.5	46	18	30	71	94	M18×1.5	15	31	27	23
F-M20X150U	18	46	20	33	77	100	M20×1.5	15	34	30	25
F-M27X200U	25	70	30	51	110	145	M27×2.0	15	50	41	37
F-M36X200U	27.5	80	35	56	125	165	M36×2.0	15	57.5	50	43



Universal Joint

